

Pairs of recessed louvred luminaires illuminate the landings and flights of stairs.

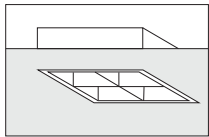

Recessed louvred luminaire for compact fluorescent lamps.

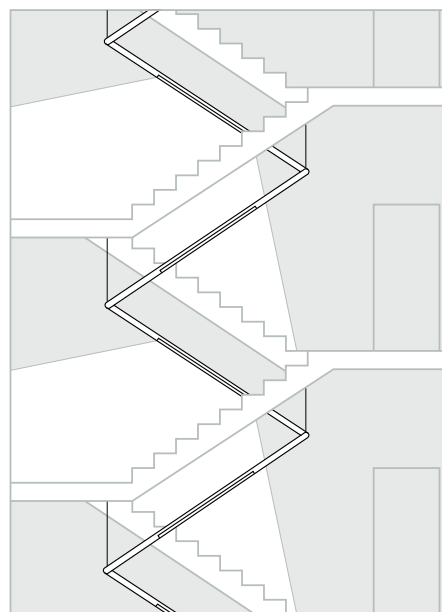
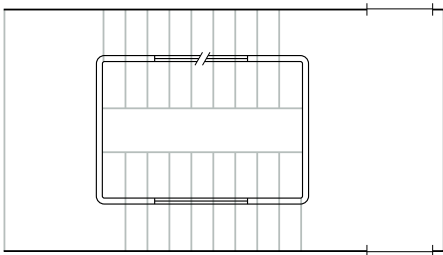

Direct and indirect luminaires in a light structure suspended in the stairwell. The structure follows the course of the staircases and crosses the landings between each flight of stairs. This avoids any complicated constructions above the centre of the landings.

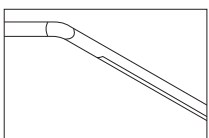

Suspended light structure with integral direct or indirect luminaires for fluorescent lamps.

4.0 Examples of lighting concepts
4.4 Staircases

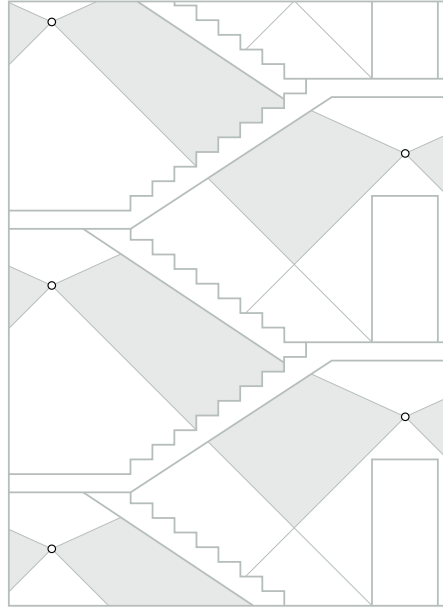
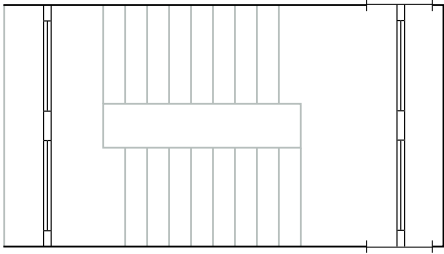

A direct-indirect light structure spanned between the walls of the stairwell above the landings provides direct and reflected light for the lighting of the adjacent flights of steps.

Light structure with integral direct-indirect luminaires for fluorescent lamps.

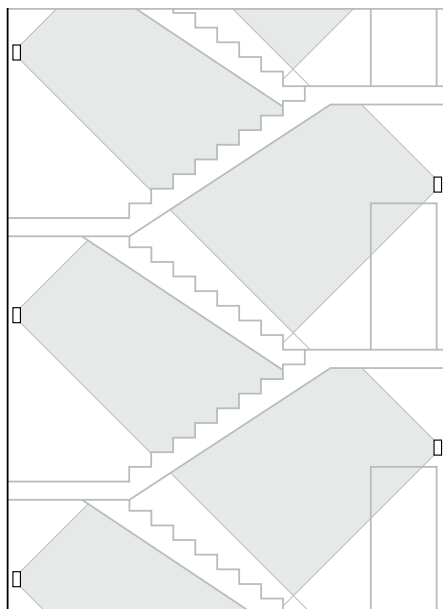
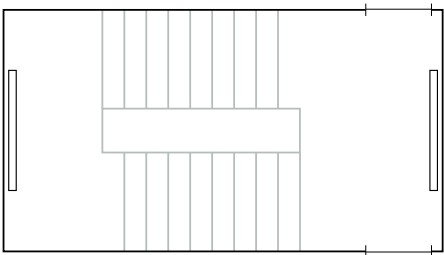
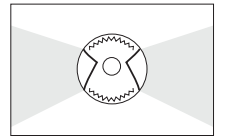
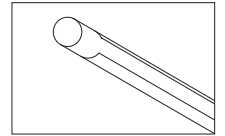

A direct-indirect wall-mounted luminaire provides adequate lighting levels on the stairs and landings.

Wall-mounted direct-indirect luminaire for fluorescent lamps.

